

Fittings

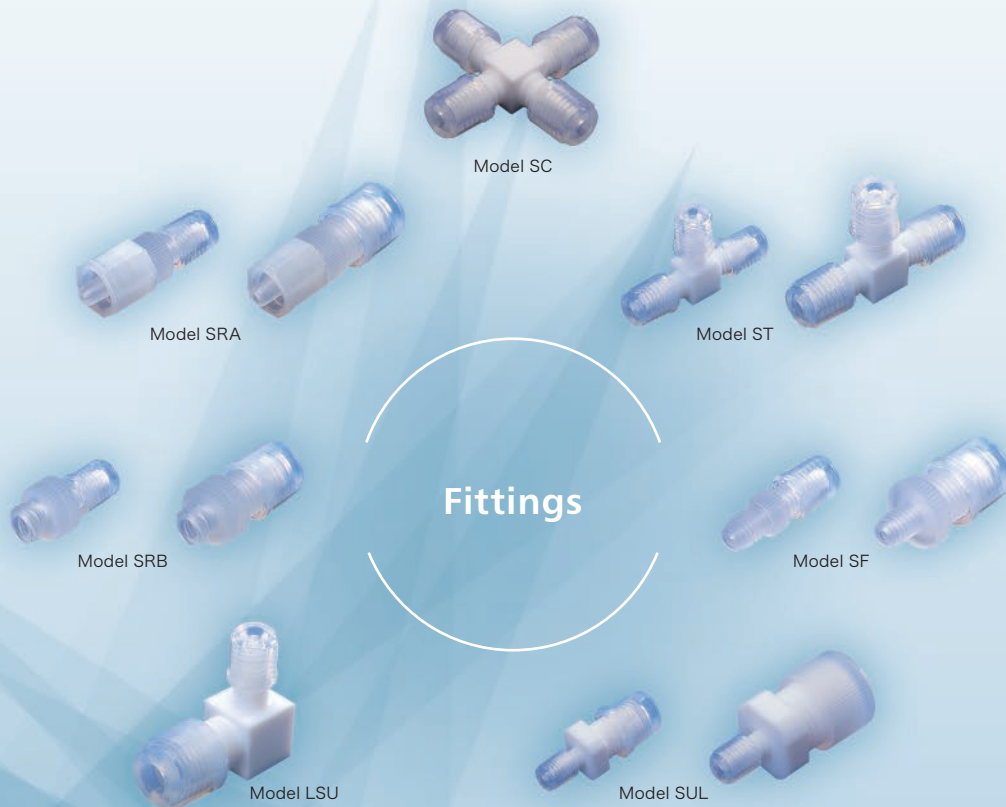

W Fitting/Luer Lock Fitting Outline	P.158
Model ST W Fitting	P.159
Model SC W Fitting	P.159
Model SU W Fitting	P.159
Model SUL W Fitting	P.161
Model LSU W Fitting	P.161

Model SF W Fitting	P.161
Model SRA Luer Lock Fitting	P.162
Model SRB Luer Lock Fitting	P.162
Nut and Ferrule Set	P.163
·Safety Instructions	P.164

W Fitting

Features : This structure has better performance by separating the sealing function (Front Ferrule) and fixing tube (Back Ferrule). Sealing by Front Ferrule and reinforcing by Back Ferrule to breaking into fluororesin tube.

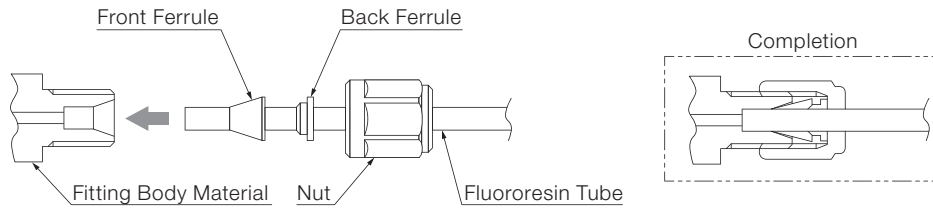

- ※Please make sure of front and back ferrule's direction and sequence.
- ※Please be sure to insert the tube completely to the last.
- ※ $\varnothing 1.6$ and $\varnothing 2$ size ferrules are made by one piece.

Luer Lock Fitting

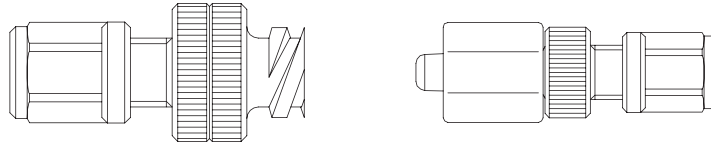

- ※Luer taper is defined by Japanese Industrial Standard (JIS) for finish processing of connector between syringe and needle. Connection strength depends on frictional force of taper thread. It is difficult to come off when you choose the lock nut type on male side.

W Fitting

MOQ : 10

Specifications
 Fluid Temperature: 10~60°C Ambient temperature: Room Temp
 Withstanding Pressure: 250kPa(at25°C)

RoHS2

Quick Connectors

Pressure Sensors

Flowmeters

Flow Controllers

Regulators

Valves

Fittings

Union T

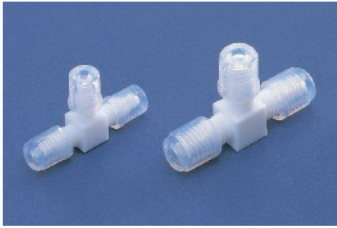

Models / Specifications

Type	(A)	(B)	Tube OD	Orifice	Wetted parts
ST-1.6	36	18	Ø1.6	Ø0.8	PTFE
ST-3	45	22	Ø3	Ø2	PTFE
ST-4	50	25	Ø4	Ø2	PTFE
ST-6	55	28	Ø6	Ø4	PTFE

Dimensions

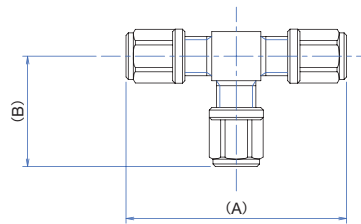

Cross



Models / Specifications

Type	(A)	(B)	Tube OD	Orifice	Wetted parts
SC-1.6	38	38	Ø1.6	Ø1	PTFE
SC-3	44	44	Ø3	Ø2	PTFE

Dimensions

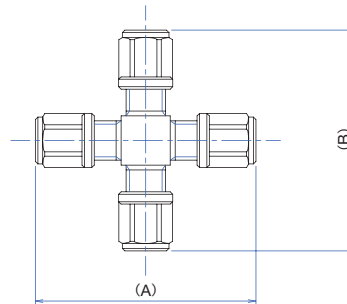

Union



Models / Specifications

Type	(A)	Tube OD	Orifice	Wetted parts
SU-1.6	33	Ø1.6	Ø1	PTFE
SU-3	39	Ø3	Ø2	PTFE
SU-4	41	Ø4	Ø3	PTFE
SU-6	47	Ø6	Ø4	PTFE

Dimensions

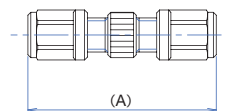

W Fittings

W Fitting

MOQ : 10

Specifications
 Fluid Temperature: 10~60°C Ambient temperature: Room Temp
 Withstanding Pressure: 250kPa(at25°C)

RoHS2

Reducing Union



Models / Specifications

Type	(A)	B	T1 Tube OD	T2 Tube OD	Orifice	Wetted parts
SUL-3-1.6	36	11	Ø3	Ø1.6	Ø0.8	PTFE
SUL-4-1.6	37	11	Ø4	Ø1.6	Ø1	PTFE
SUL-4-3	42	11	Ø4	Ø3	Ø2	PTFE
SUL-6-1.6	41	14	Ø6	Ø1.6	Ø1	PTFE
SUL-6-3	44	14	Ø6	Ø3	Ø2	PTFE

Dimensions

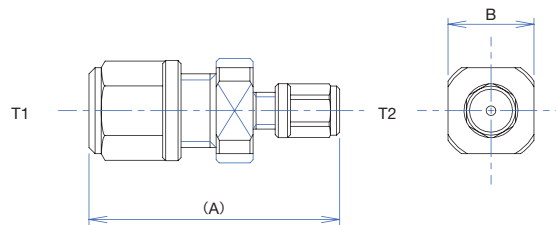
 Union Elbow
 Reducing Union Elbow

Models / Specifications

Type	(A)	(B)	C	T1 Tube OD	T2 Tube OD	Wetted parts
LSU-3	27	27	10	Ø3	Ø3	PTFE
LSU-6	35	35	14	Ø6	Ø6	PTFE
LSU-6-1.6	35	30	14	Ø1.6	Ø6	PTFE
LSU-6-3	35	31	14	Ø3	Ø6	PTFE

Dimensions

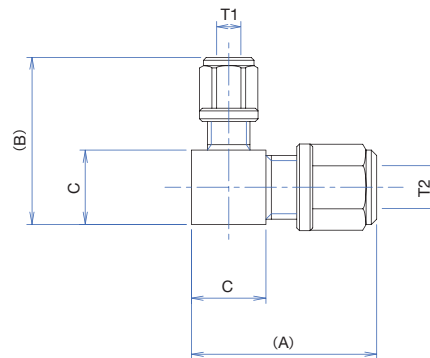

W Fitting

MOQ : 10

Specifications
 Fluid Temperature: 10~60°C Ambient temperature: Room Temp
 Withstanding Pressure: 250kPa(at25°C)

RoHS2

Quick Connectors

Pressure Sensors

Flowmeters

Flow Controllers

Regulators

Valves

Fittings

Half Union



Models / Specifications

Type	(A)	Tube OD	Orifice	Wetted parts
SF-M6-1.6	26	Ø1.6	Ø0.8	PCTFE, PTFE
SF-M6-3	29	Ø3	Ø2	PCTFE, PTFE
SF-M6-4	30	Ø4	Ø2	PCTFE, PTFE
SF-M6-6	33	Ø6	Ø2	PCTFE, PTFE

Dimensions

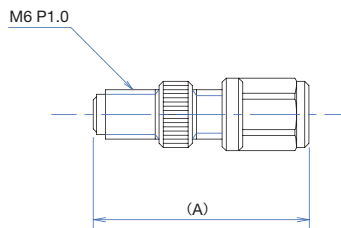

Male Connector



Models / Specifications

Type	(A)	B	R thread	Tube OD	Orifice	Wetted parts
SF-1/8-1.6	29	11	R1/8	Ø1.6	Ø1	PTFE
SF-1/8-3	32	11	R1/8	Ø3	Ø2	PTFE
SF-1/8-6	36	13	R1/8	Ø6	Ø4	PTFE
SF-1/4-3	35	14	R1/4	Ø3	Ø2	PTFE
SF-1/4-4	37	14	R1/4	Ø4	Ø2	PTFE
SF-1/4-6	40	14	R1/4	Ø6	Ø4	PTFE
SF-3/8-6	41	17	R3/8	Ø6	Ø4	PTFE

Dimensions

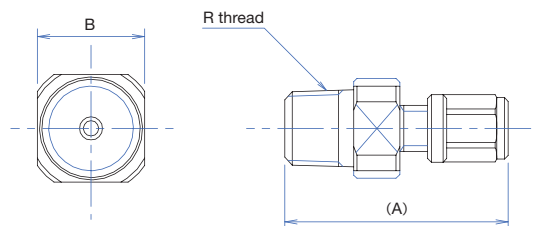

Luer Lock Fittings

Luer Lock Fitting

MOQ : 10

Specifications Fluid Temperature: Room Temp
Ambient temperature: Room Temp
Withstanding Pressure: 250kPa

RoHS2

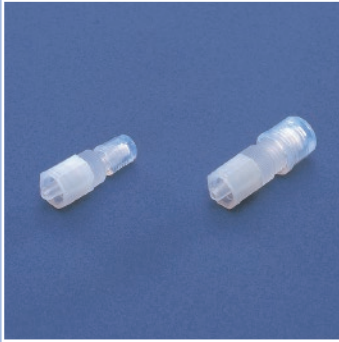

Models / Specifications

Type	(A)	Tube OD	Orifice	Wetted parts
SRA-1.6-L	33	Ø1.6	Ø1	PCTFE, PTFE
SRA-2-L	34	Ø2	Ø1	PCTFE, PTFE
SRA-3-L	37	Ø3	Ø1.5	PCTFE, PTFE
SRA-4-L	37	Ø4	Ø2	PCTFE, PTFE
SRA-6-L	41	Ø6	Ø2	PCTFE, PTFE
SRA-M6	23	M6 thread	Ø1.5	PCTFE

※SRA-M6 doesn't have Lock Nut.

Dimensions

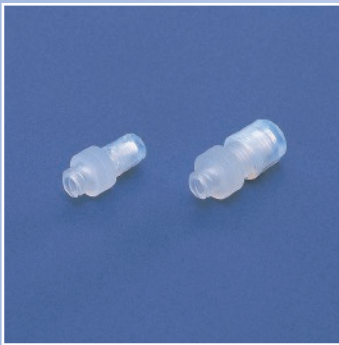
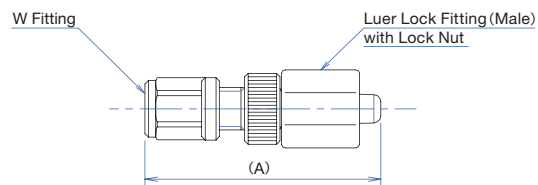

Models / Specifications

Type	(A)	Tube OD	Orifice	Wetted parts
SRB-1.6	26	Ø1.6	Ø1	PCTFE, PTFE
SRB-2	26	Ø2	Ø1	PCTFE, PTFE
SRB-3	29	Ø3	Ø1	PCTFE, PTFE
SRB-4	30	Ø4	Ø2	PCTFE, PTFE
SRB-6	32	Ø6	Ø2	PCTFE, PTFE
SRB-M6	15.8	M6 thread	Ø1.5	PCTFE

Dimensions

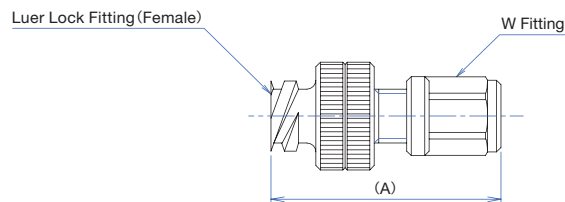

Nut and Ferrule set

MOQ : 10

RoHS2

■ Connection Size: Ø1.6, Ø2, Ø3, Ø4 and Ø6

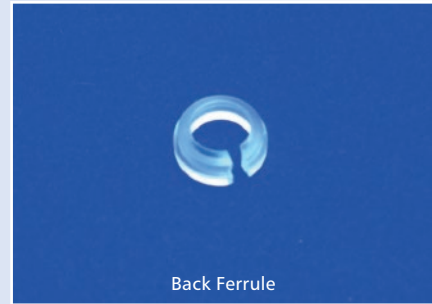
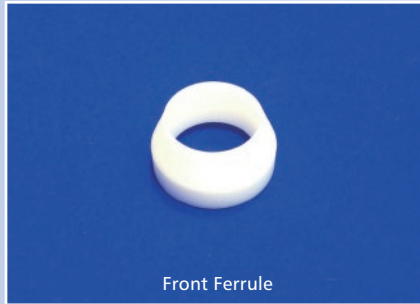

Models / Specifications

Type	Tube OD	Material		
		Nut	Front Ferrule	Back Ferrule
Ø1.6·Ø2 Nut	Ø1.6·Ø2	PFA	—	—
Ø1.6 Ferrule	Ø1.6	—	PTFE (one-piece)	
Ø1.6 Nut set		PFA	PTFE (one-piece)	
Ø2 Ferrule	Ø2	—	PTFE (one-piece)	
Ø2 Nut set		PFA	PTFE (one-piece)	
Ø3 Nut	Ø3	PFA	—	—
Ø3 Ferrule set		—	PTFE	PTFE
Ø3 Nut set		PFA	PTFE	PTFE
Ø4 Nut	Ø4	PFA	—	—
Ø4 Ferrule set		—	PTFE	PCTFE
Ø4 Nut set		PFA	PTFE	PCTFE
Ø6 Nut	Ø6	PFA	—	—
Ø6 Ferrule set		—	PTFE	PCTFE
Ø6 Nut set		PFA	PTFE	PCTFE

W Fittings / Luer Lock Fittings / Nut·Ferrule sets

● Safety Instructions



- Before using the product, read the instruction manual carefully and use it correctly. We are not liable for accidents that occurred during use other than those described in the instruction manual.
- Refer to the product specification and use under the appropriate condition.
- Before using product, confirm the compatibility with the material, fluid and environment temperature.
- Excessive tightening might lead to leak and break down.
- When you find a leakage or loose at regular check, replace the ferrule to new one.
- When using W fitting, tube to solid material such as PFA.
- Make sure not to drop liquid onto the product.
- When using W fitting, make sure of front and back ferrule's direction and sequence.
- Be sure to insert the tube completely to the last.
- Do not use with a fluid that contains foreign materials.
- Be careful to handle the coagulate and abrasive fluids not to solid inside the pipe.
- Piping not to be strengthen outside from any directions.
- Do not use the product in a harsh environment where fluid temperature changes rapidly and product vibrates and impacts from outside, as this may cause damage to the product.
- Regular check must be processed under using on gas permeable fluids for your safety.